

Site conditions are indicative only.
Indicative plan layout. Furniture shown for purposes of illustration.
Internal ceiling height: 2600mm
Vertical timber cladding.
Aluminium window frames.
Roof mounted solar PV.
Net Floor Area (including linings and partitions): 73.7sqm
Gross Floor Area: 79.2sqm
External Wall Area (excluding openings): 108.7sqm
Internal Wall Area (excluding openings): 30.1sqm

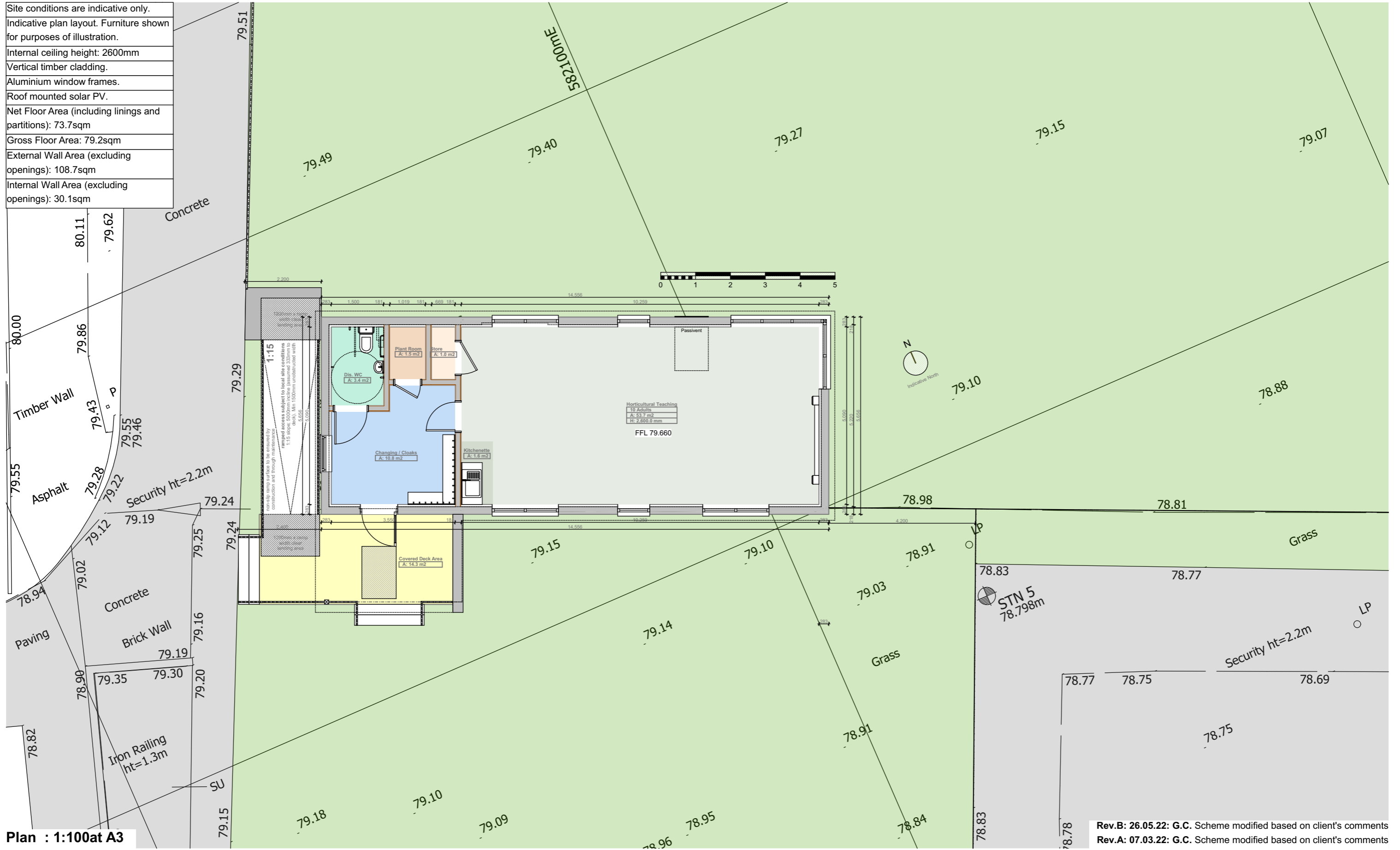

Plan : 1:100at A3

Rev.B: 26.05.22: G.C. Scheme modified based on client's comments
Rev.A: 07.03.22: G.C. Scheme modified based on client's comments